

TOP VIEW

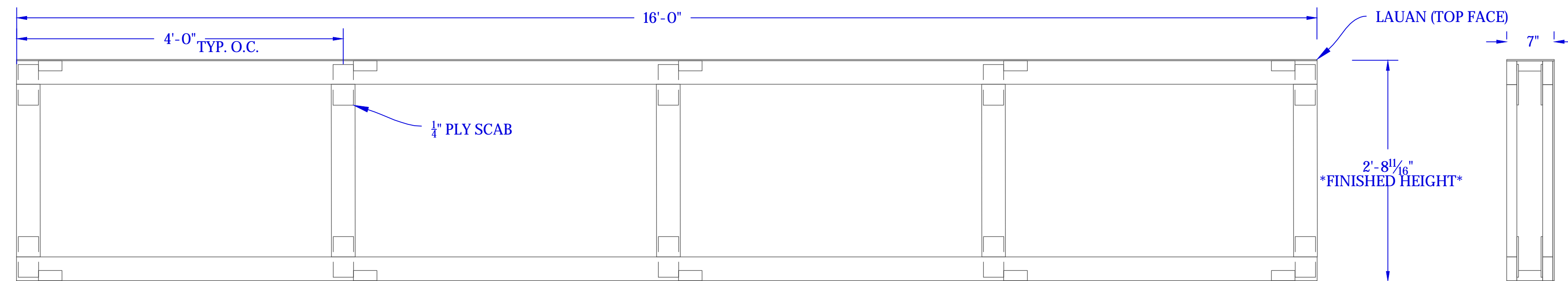

FRONT VIEW - SKIN REMOVED

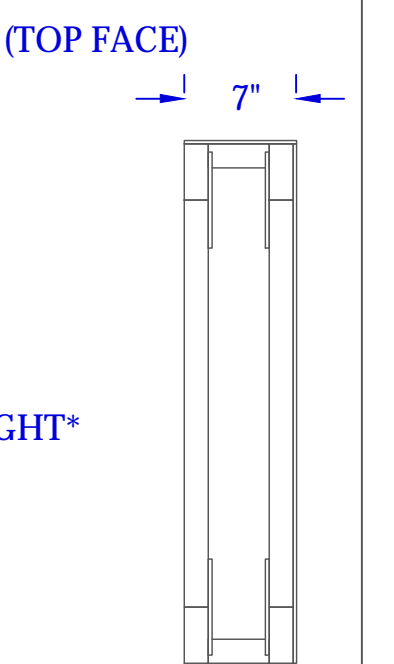

SIDE VIEW

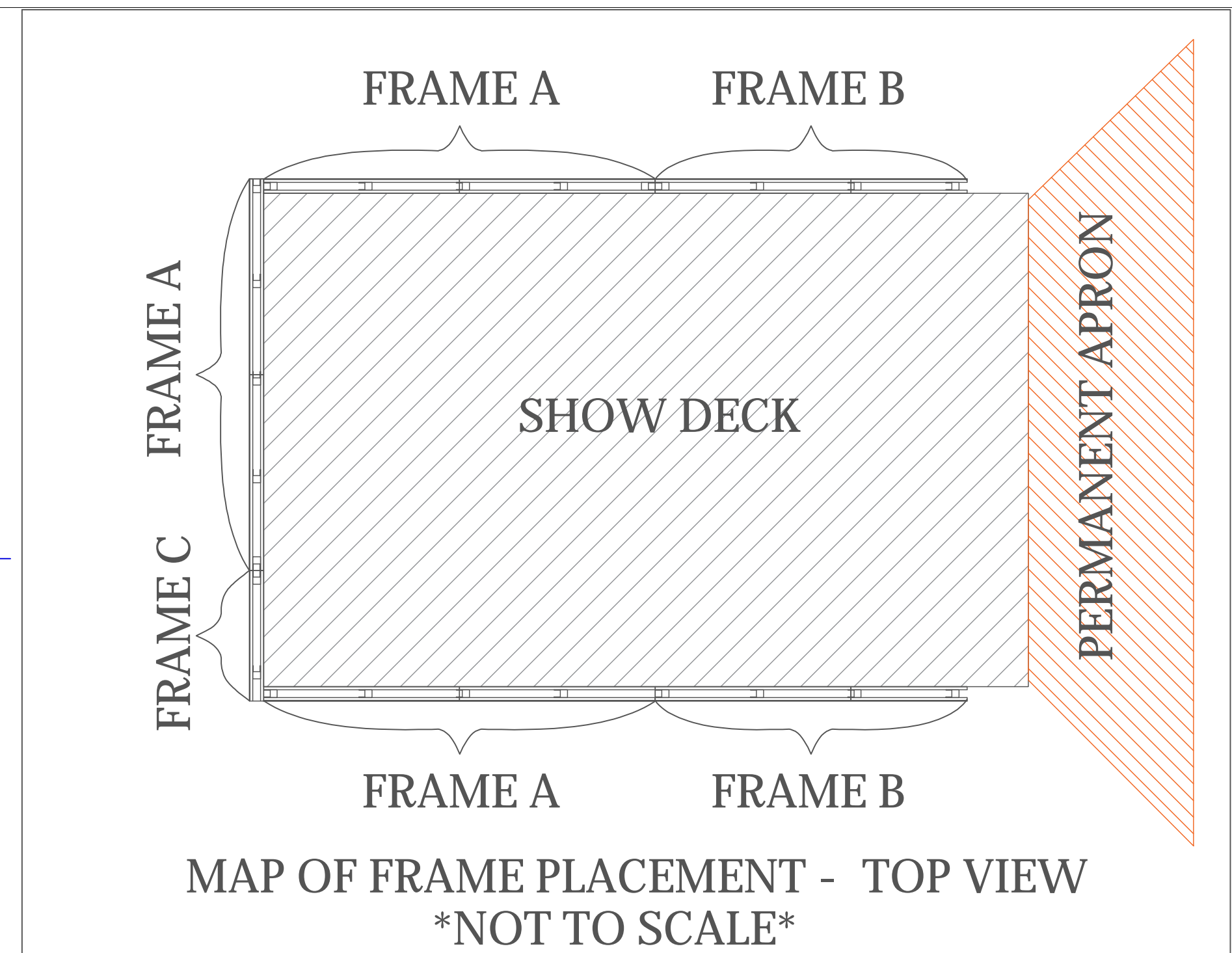

MAP OF FRAME PLACEMENT - TOP VIEW  
\*NOT TO SCALE\*

JOB #2

FRAME A  
BUILD 3 (SL/SR/DS)

NOTES:

- \*2X4 FRAMING WITH 1/4" PLY SCABS
- \*SKIN ON FRONT AND TOP WITH LAUAN

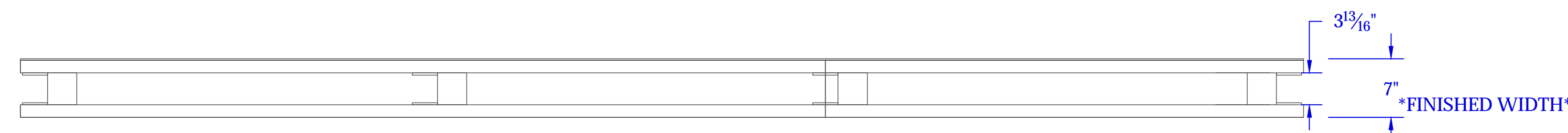

TOP VIEW

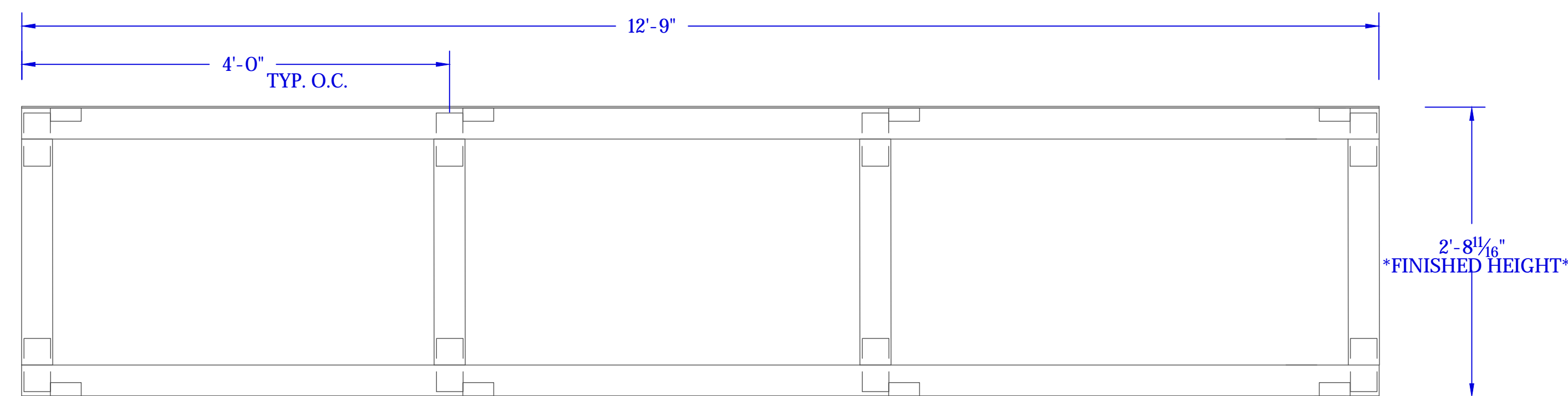

FRONT VIEW - SKIN REMOVED

SIDE VIEW

FRAME B  
BUILD 2 (SR/SL)

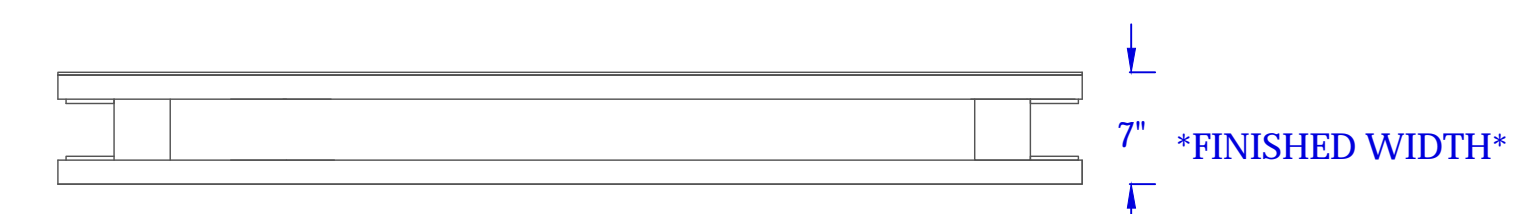

TOP VIEW

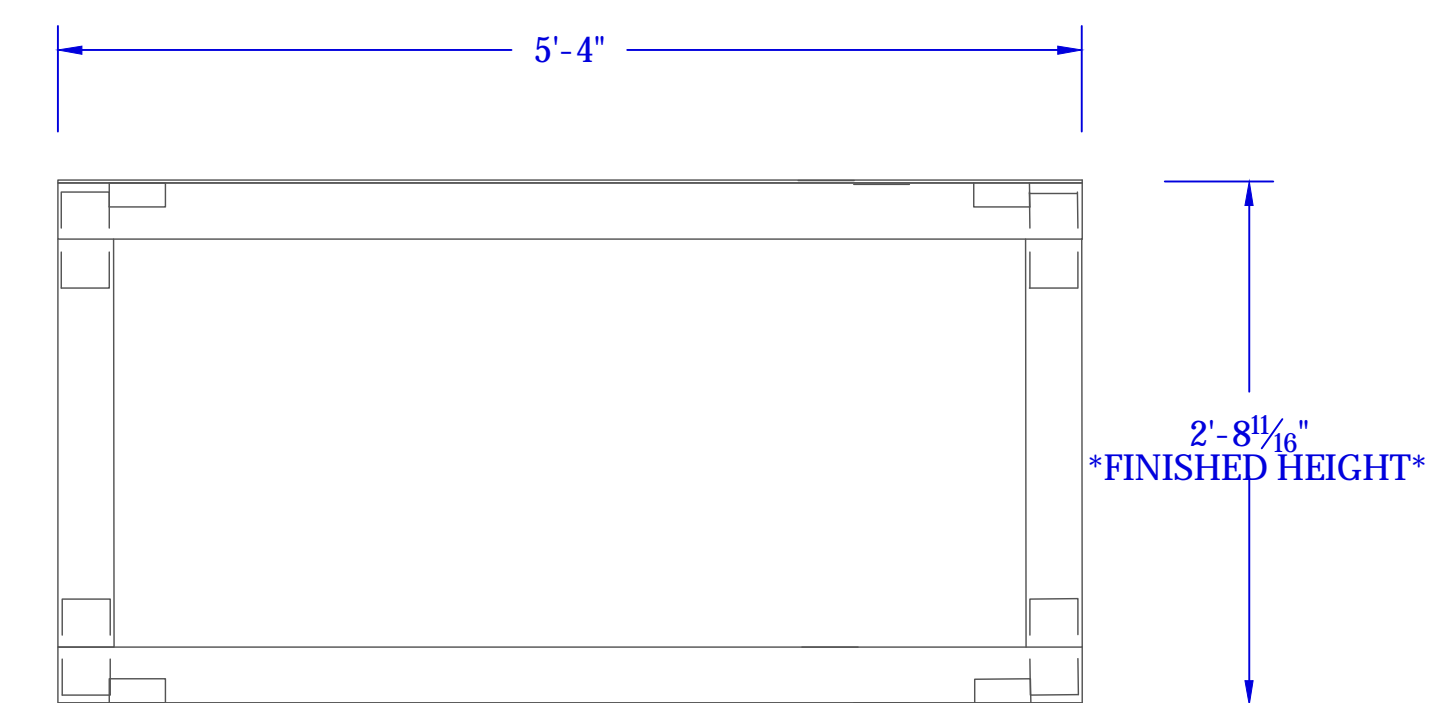

FRONT VIEW - SKIN REMOVED

SIDE VIEW

FRAME C  
BUILD 1 (DS)

REVISION:	DIRECTOR: LISA ROTHE
	DESIGNER: LEE SAVAGE
	TECHNICAL DIRECTOR: LAURA PATES
	DRAWN BY: MACKENZIE KOVAKA
SCALE: 3/8 = 1'-0"	DETROIT '67
	FOUNDATION WALL FRAMES
DATE: 8/14/2016	PLAYMAKERS REPERTORY THEATER
PLATE NO.	PAUL GREEN THEATER
	OF 2